



### BAS40/-04/-05/-06 SURFACE MOUNT SCHOTTKY BARRIER DIODE

#### Features

- Low forward voltage
- Fast switching

BAS40 Marking Code: **43**

BAS40-04 Marking Code: **44**

BAS40-05 Marking Code: **45**

BAS40-06 Marking Code: **46**

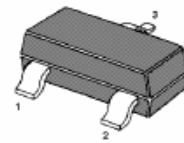
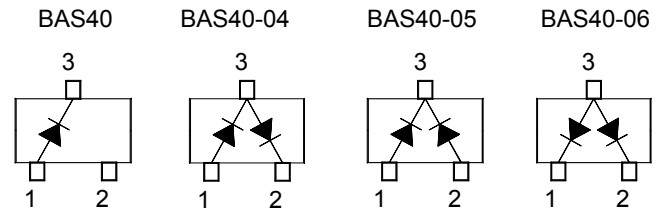

SOT-23

#### Absolute Maximum Ratings ( $T_a = 25\text{ }^\circ\text{C}$ )

Parameter	Symbol	Value	Unit
Repetitive Peak Reverse Voltage	$V_{RRM}$	40	V
DC Blocking Voltage	$V_R$	40	V
Forward Continuous Current	$I_F$	200	mA
Peak Forward Surge Current (at $t_p < 1\text{ s}$ )	$I_{FSM}$	600	mA
Junction Temperature	$T_J$	150	$^\circ\text{C}$
Storage Temperature Range	$T_S$	- 55 to + 150	$^\circ\text{C}$

#### Characteristics at $T_a = 25\text{ }^\circ\text{C}$

Parameter	Symbol	Min.	Max.	Unit
Forward Voltage at $I_F = 1\text{ mA}$	$V_F$	-	0.38	V
at $I_F = 40\text{ mA}$	$V_F$	-	1	V
Reverse Current at $V_R = 25\text{ V}$	$I_R$	-	200	nA
Reverse Breakdown Voltage at $I_R = 10\text{ }\mu\text{A}$	$V_{(BR)R}$	40	-	V
Reverse Recovery Time from $I_F = 10\text{ mA}$ through $I_R = 10\text{ mA}$ to $I_R = 1\text{ mA}$	$t_{rr}$	-	5	ns
Total Capacitance at $V_R = 0\text{ V}$ , $f = 1\text{ MHz}$	$C_T$	-	5	pF



## Typical Characteristics

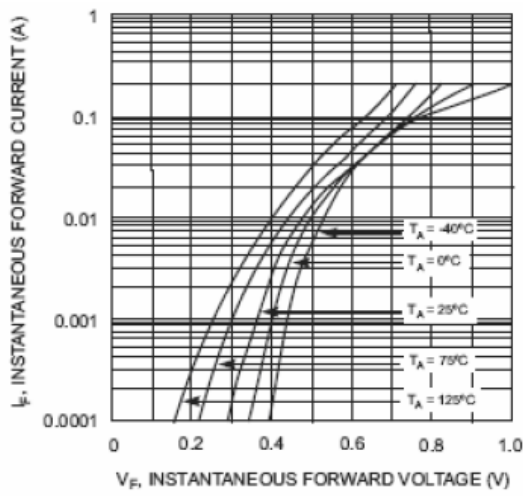

Fig. 1 Typical Forward Voltage

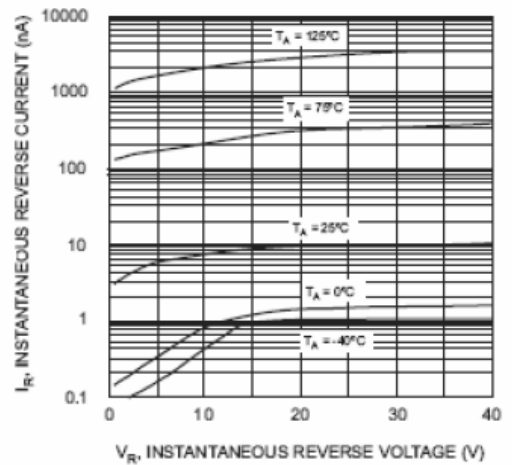

Fig. 2 Typical Reverse Characteristics

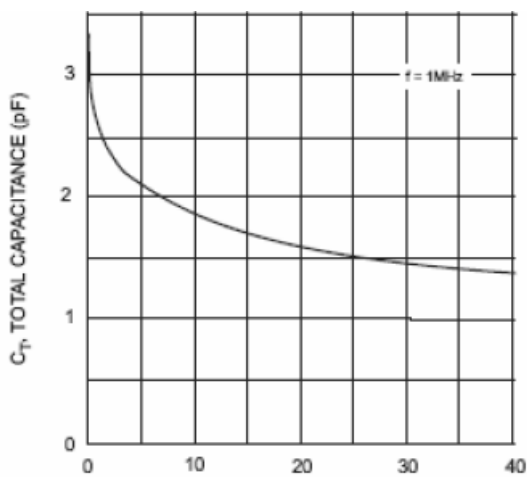

Fig. 3 Typical Capacitance

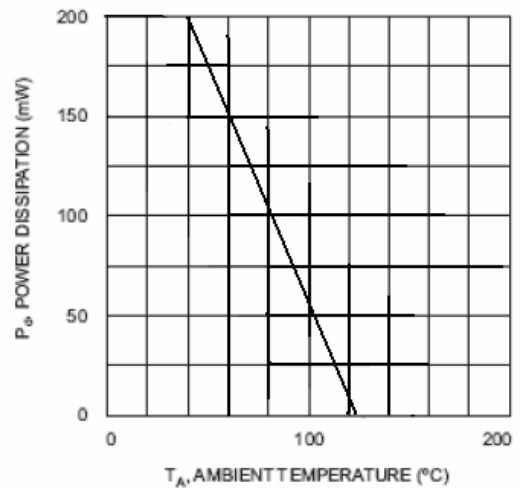

Fig. 4 Power Derating Curve, Total Package



## PACKAGE OUTLINE

Plastic surface mounted package; 3 leads

SOT-23

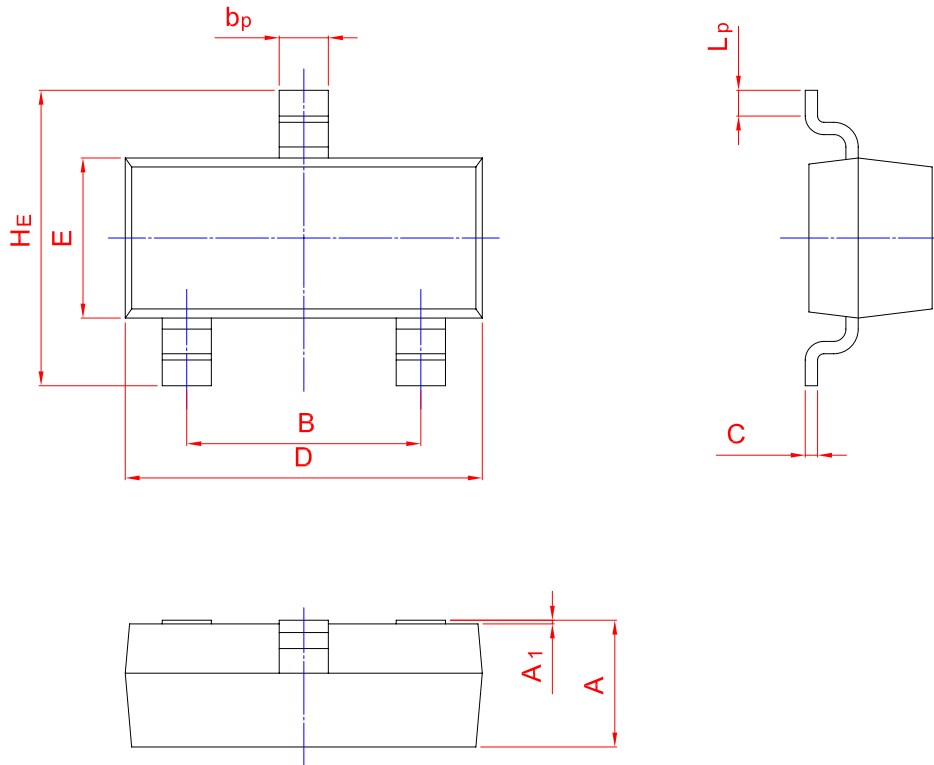
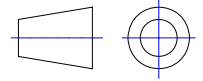

UNIT	A	B	bp	C	D	E	He	A1	Lp
mm	1.40	2.04	0.50	0.19	3.10	1.65	3.00	0.100	0.50
	0.95	1.78	0.35	0.08	2.70	1.20	2.20	0.013	0.20