



## 1SS294 SCHOTTKY DIODES

### FEATURES

Extremely Fast Switching Speed

Marking : A9

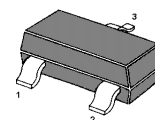
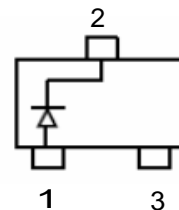

**SOT-23**

### Maximum Ratings @T<sub>A</sub>=25°C

Parameter	Symbol	Limits	Unit
Peak Repetitive Peak reverse voltage	V <sub>RRM</sub>	40	V
Working Peak Reverse Voltage	V <sub>RWM</sub> V <sub>R</sub>		
Forward Continuous Current	I <sub>FM</sub>		
Power Dissipation	P <sub>D</sub>	200	mW
Storage temperature	T <sub>STG</sub>	-55-150	°C

### Electrical Characteristics @T<sub>A</sub>=25°C

Parameter	Symbol	Min.	Typ.	Max.	Unit	Conditions
Reverse Breakdown Voltage	V <sub>(BR)R</sub>	40			V	I <sub>R</sub> =100μA
Forward voltage	V <sub>F</sub>			0.32	V	I <sub>F</sub> =1mA
	V <sub>F</sub>			0.5	V	I <sub>F</sub> =10mA
	V <sub>F</sub>			0.6	V	I <sub>F</sub> =100mA
Reverse current	I <sub>R</sub>			5	μA	V <sub>R</sub> =40V
Diode Capacitance	C <sub>D</sub>			25	pF	V <sub>R</sub> =1V, f=1MHz
Reverse Recovery Time	t <sub>rr</sub>			5	nS	I <sub>F</sub> =I <sub>R</sub> =10mA I <sub>rr</sub> =0.1X I <sub>R</sub> , R <sub>L</sub> =100Ω



## Typical Characteristics

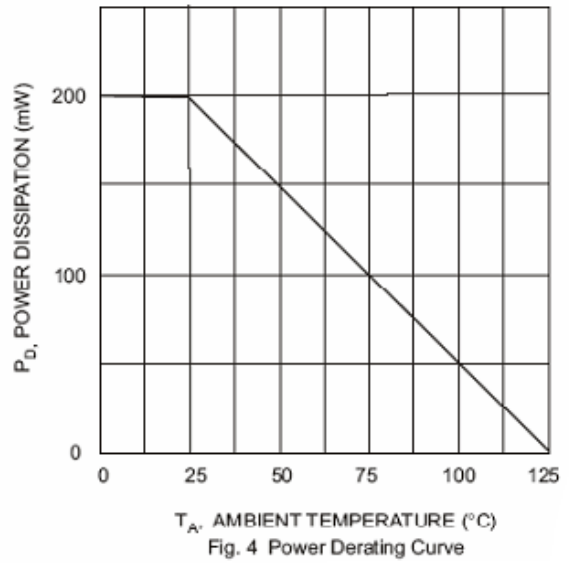
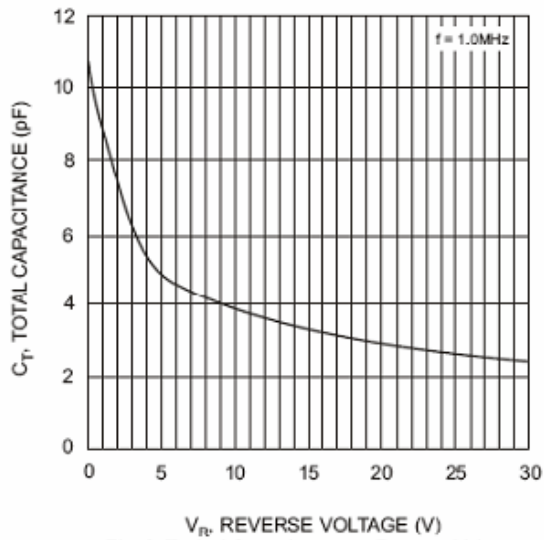
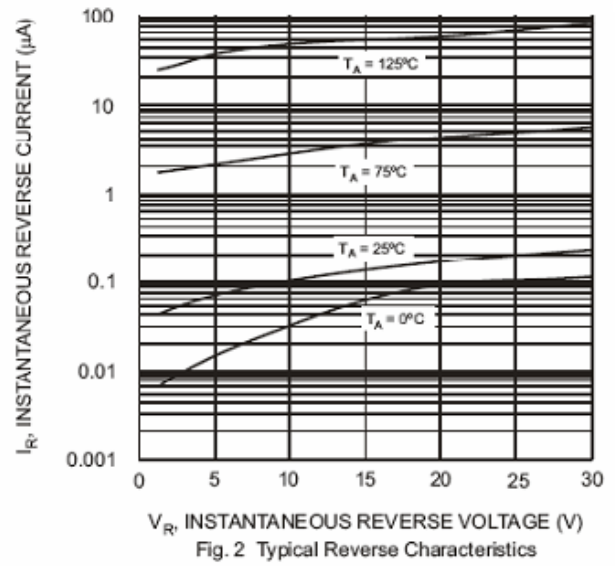
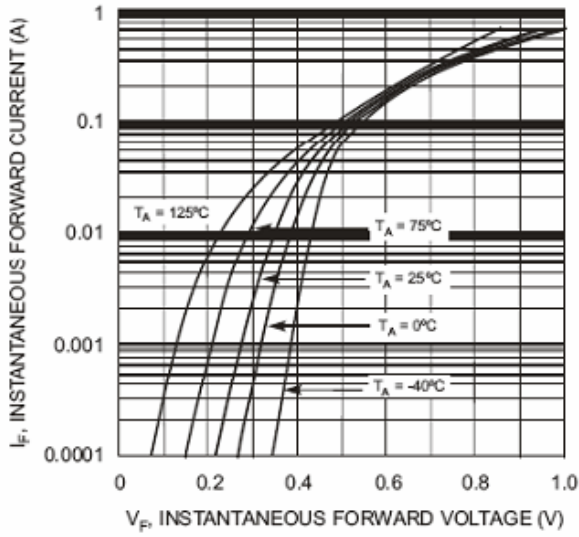



## PACKAGE OUTLINE

Plastic surface mounted package; 3 leads

SOT-23

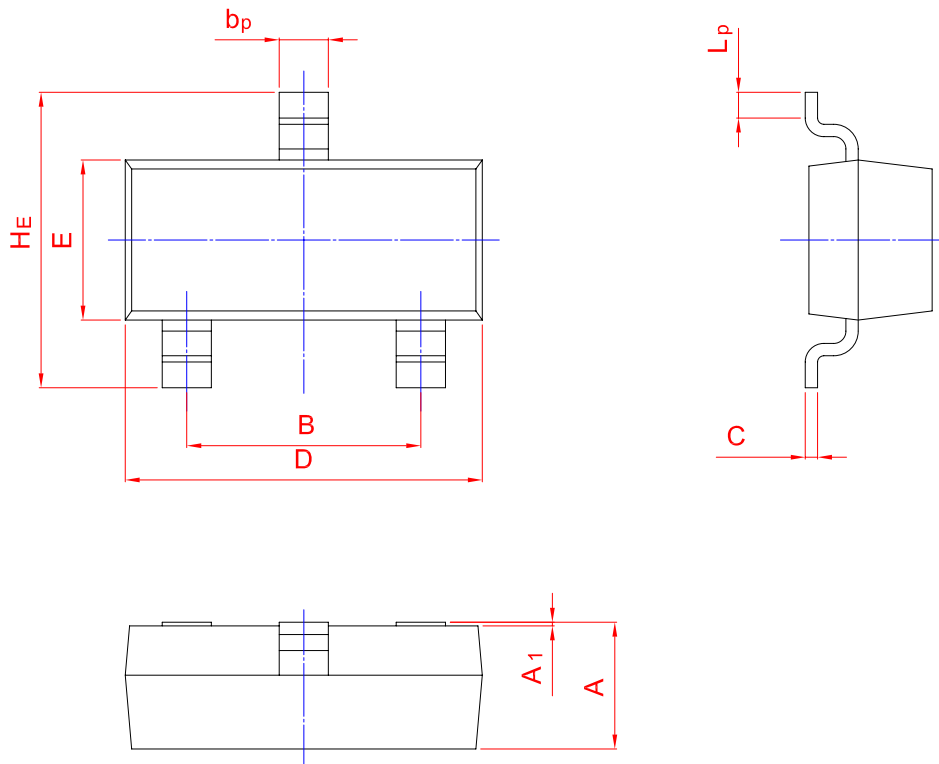
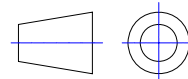

UNIT	A	B	b <sub>p</sub>	C	D	E	H <sub>E</sub>	A <sub>1</sub>	L <sub>p</sub>
mm	1.40	2.04	0.50	0.19	3.10	1.65	3.00	0.100	0.50
	0.95	1.78	0.35	0.08	2.70	1.20	2.20	0.013	0.20